

# CANADAIR DYNATRAC

U.S. ARMY XM-571

ALL TERRAIN  
ALL PURPOSE  
VEHICLE

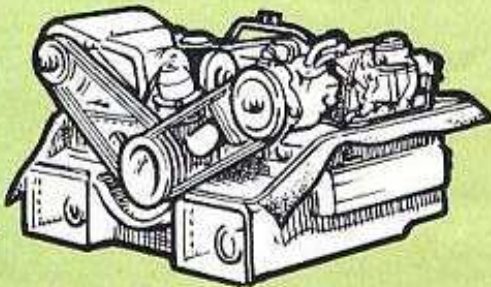
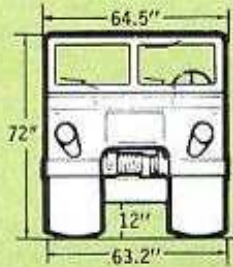
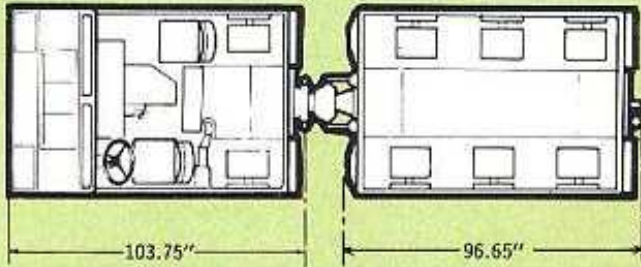
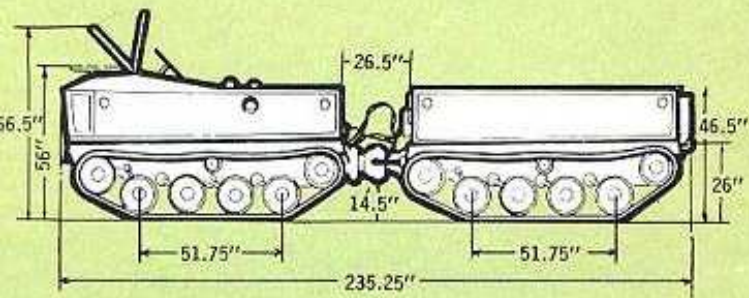

CORVAIRE ENGINE

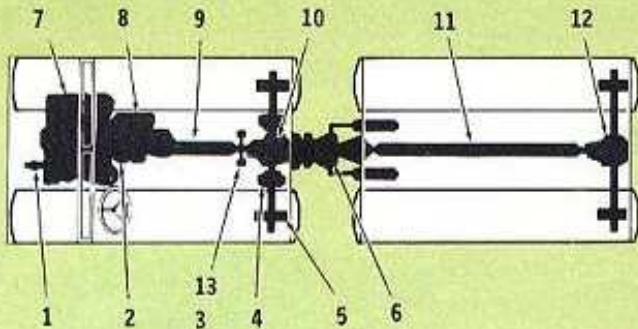

- |                                |                                   |
|--------------------------------|-----------------------------------|
| 1 WINCH DRIVE-SHAFT            | 9 DRIVE SHAFT                     |
| 2 TWO-SPEED DROP BOX           | 10 DRIVE - THROUGH HYPOID GEARBOX |
| 3 DISC BRAKE                   | 11 REAR UNIT DRIVE SHAFT          |
| 4 CLUTCH-BRAKE ASSEMBLY        | 12 DRIVE - THROUGH HYPOID GEARBOX |
| 5 SPROCKET DRIVE               | 13 PARKING BRAKE                  |
| 6 ARTICULATION JOINT           |                                   |
| 7 CORVAIRE ENGINE              |                                   |
| 8 4-SPEED TRANSMISSION GEARBOX |                                   |



CANADAIR LIMITED P.O. BOX 6087, MONTREAL, CANADA  
A SUBSIDIARY OF GENERAL DYNAMICS CORPORATION

## THE CANADAIR DYNATRAC

The Canadair DYNATRAC is a full tracked, articulated, high mobility, utility carrier which has been adapted to many military roles including troop carrier, cargo carrier, weapons carrier and platform, field ambulance, and radio command post.

The vehicle consists of a front and rear unit with all tracks driven by a single air-cooled engine in the front unit. Steering is accomplished by the action of hydraulic actuators applying forces between the two units. When desired, the front unit may be operated alone. In this case, steering is accomplished by a conventional clutch-brake system.

The DYNATRAC is light enough to be transported, with 2000 pound payload or 10 fully equipped soldiers, by medium helicopter or transport aircraft into areas which are otherwise inaccessible. Once in these areas the vehicle has unlimited off-road mobility.

It has been proven by rigorous trials under actual service conditions in the U.S.A., Norway, Canada and Alaska that it meets the U.S. Army specifications for a multi-terrain vehicle that can operate in all climates from  $-65^{\circ}\text{F}$  to  $115^{\circ}\text{F}$  in jungle swamps, mud, marshes, deep snow, tundra, muskeg, sand and rocky ground. Its swimming ability permits it to cross inland water bodies without special preparation.

For cold weather operation, personnel in both front and rear sections of the vehicle are protected by easily attachable arctic cabs which are provided with heaters. The heater in the front cab is also available for engine and battery warm-up for easy starting.

The DYNATRAC design permits the addition of a third articulated unit which is powered in the same way as the second unit. This increases the vehicle payload capacity to 3500 pounds for air transport and amphibious operations, and 5000 pounds for all other operations.

## PERFORMANCE

Operating Speed	30 mph
Range	300 miles
Longitudinal slopes	over 60%
Side slopes	over 40%
Vertical Wall	18 inches
Turning Circle	20 ft. radius
Swimming speed	2 mph

Payloads	All Terrain	Amphibious Operation
One unit	1000 lb.	750 lb.
Two units	3000 lb.	2000 lb.
Three units	5000 lb.	3500 lb.



## ROLES

Personnel & Cargo Carrier, Ambulance  
Communications Center

Weapons Systems Carrier, for:  
7.62 mm. Machine Gun  
106 mm. Recoilless Rifle  
Davy Crocket, TOW.

Can be airlifted by STOL Army aircraft or medium helicopters such as CV-2 Caribou and CH. 47A Chinook.

